

# DARK WINGS

## Rubber Band Powered Ornithopter



The product is not suitable for children under 14 years of age.  
 Please carefully read instructions before assembling. Any errors in assembly may result in poor flying performance.  
 Choose a wide-open area with few people to fly the plane.  
 Do not launch the plane in the direction of other people.  
 Do not fly the plane near high-voltage electrical lines or crowds of people.

**Carbon fiber fuselage**

T1 3'3'160mm

T2 155mm

T3 170mm

T4 210mm

T4 210mm

**Double-sided tape**

Sheet material

Rubber band

P1 P2 P3 P4 P5

Panel A

### Installation

#### 1 Assemble the nose

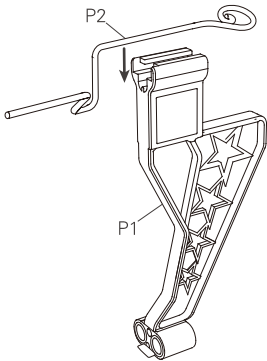

Insert crank P2 from the nose of the plane into the bottom of slot P1 as shown in the diagram, with the bend kept vertical and pointing downward.

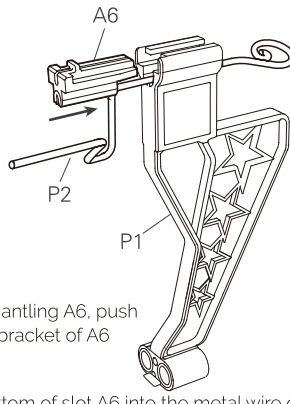

\*When dismantling A6, push the bottom bracket of A6 outward.

Insert the bottom of slot A6 into the metal wire of the nose, then push it horizontally into slot P1 in a horizontal direction. Once correctly assembled, P2 can shake smoothly.

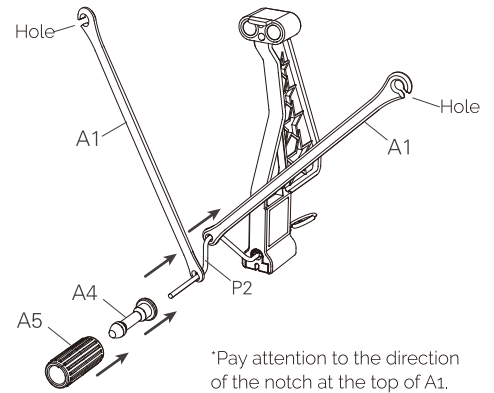

\*Pay attention to the direction of the notch at the top of A1.

As the diagram shows, attach A1 to the bend in crank P2 of the airplane nose, then install A4 and A5 in that order.

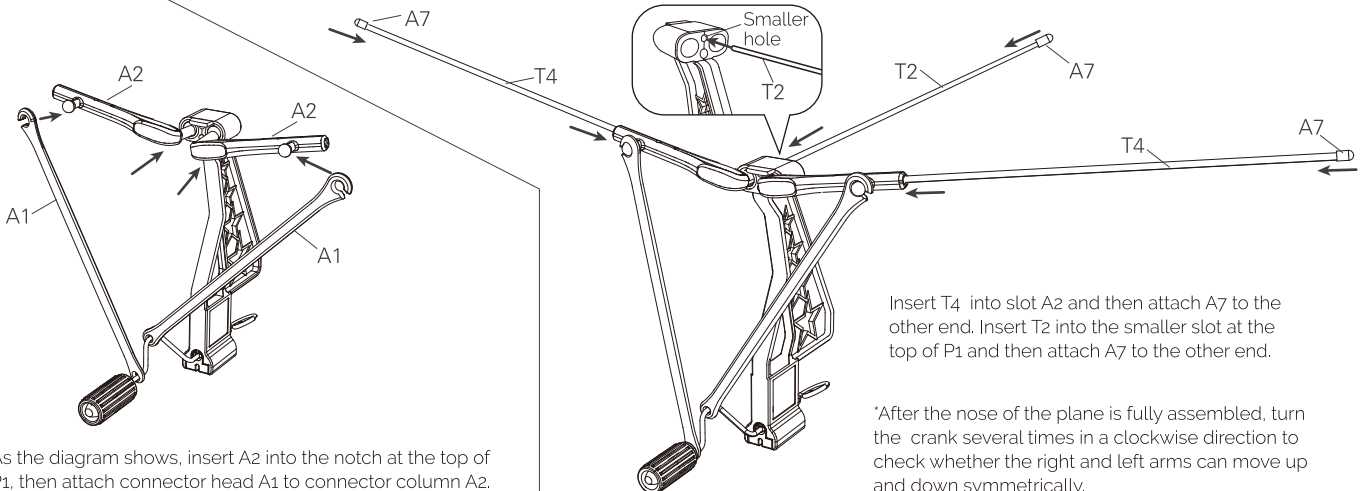

As the diagram shows, insert A2 into the notch at the top of P1, then attach connector head A1 to connector column A2.

Insert T4 into slot A2 and then attach A7 to the other end. Insert T2 into the smaller slot at the top of P1 and then attach A7 to the other end.

\*After the nose of the plane is fully assembled, turn the crank several times in a clockwise direction to check whether the right and left arms can move up and down symmetrically.

## 2 Stick the sheet

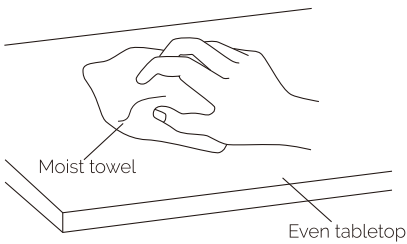

First, use a moist towel to wipe the surface of the table, then place the sheet material for the wings and tail separately onto the tabletop with the unprinted side facing up.

\*Stick one end of the double-sided tape to the tabletop.

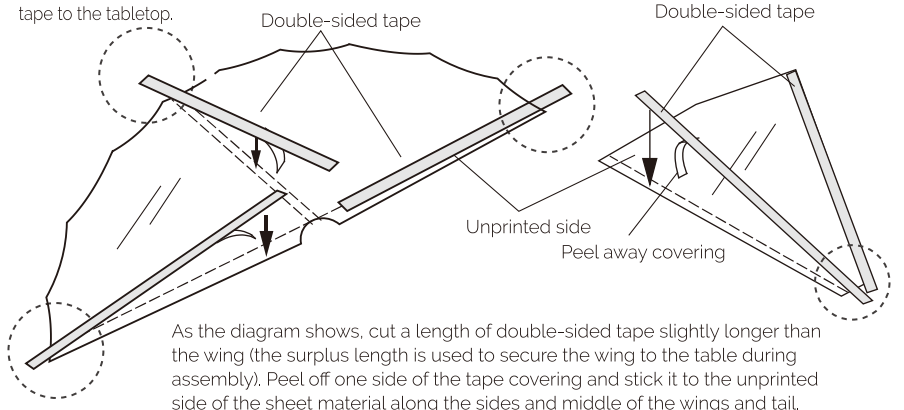

As the diagram shows, cut a length of double-sided tape slightly longer than the wing (the surplus length is used to secure the wing to the table during assembly). Peel off one side of the tape covering and stick it to the unprinted side of the sheet material along the sides and middle of the wings and tail.

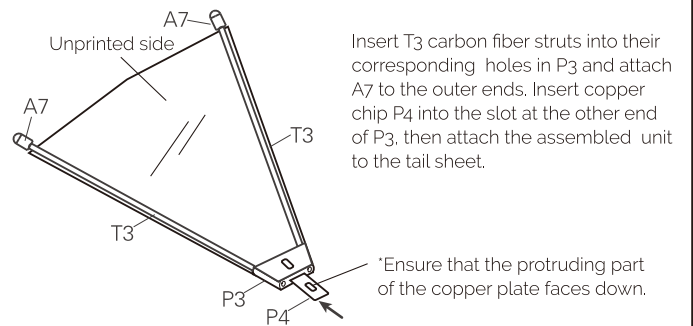
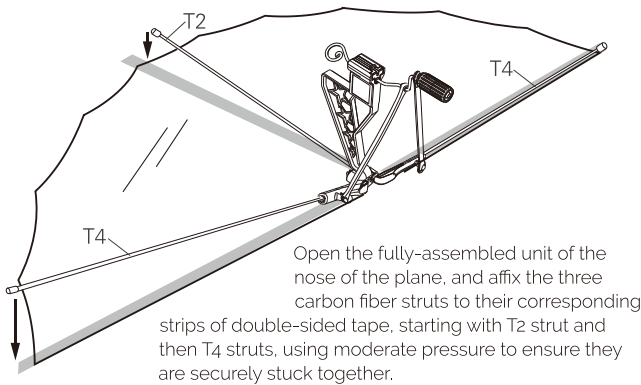

## 3 Final assembly

Insert one end of T1 into the square slot at the bottom of P1, then fold the tail upward about 15 degrees. Twist the rubber band 9 times and hook it onto the front and plane rear, with the knotted end at the tail.

\*You can add A3 as needed to adjust the weight of the plane (read the fly guide for details).

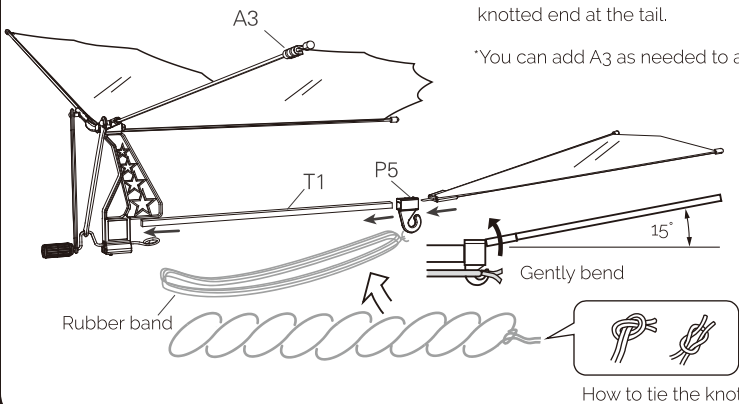

## Fly Guide

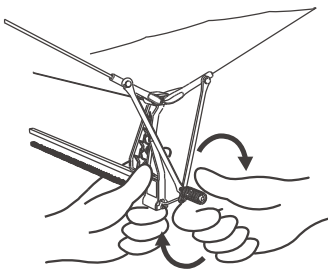

Hold A5 and turn the crank clockwise about 50 times. FAI rubber band is recommended (Supplied by ZT Model).

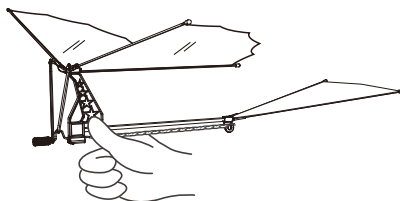

Let go with your left hand and wait for the wings to begin flapping, then gently throw the airplane forward with your right hand.

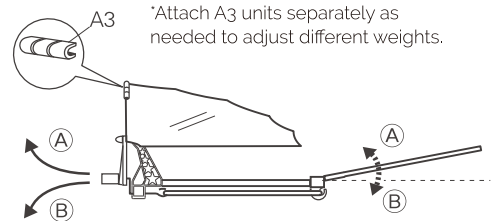

You can adjust the climbing angle of the plane by bending the tail higher or lower. The flight path can be changed by adding A3 to the ends of the struts or adjusting their positions.